

CERTIFICATE OF LOCATION OF GOVERNMENT CORNER

REFERENCE (East Line) Corner of Section 11 , Township 107, Range 41 5th P.M.

STATE OF MINNESOTA, County of Murray.

Statement: Sept. 28, 1989 - Placed a Minnesota Department of Transportation Cast Iron Monument.

SKETCH OF REFERENCE TIES

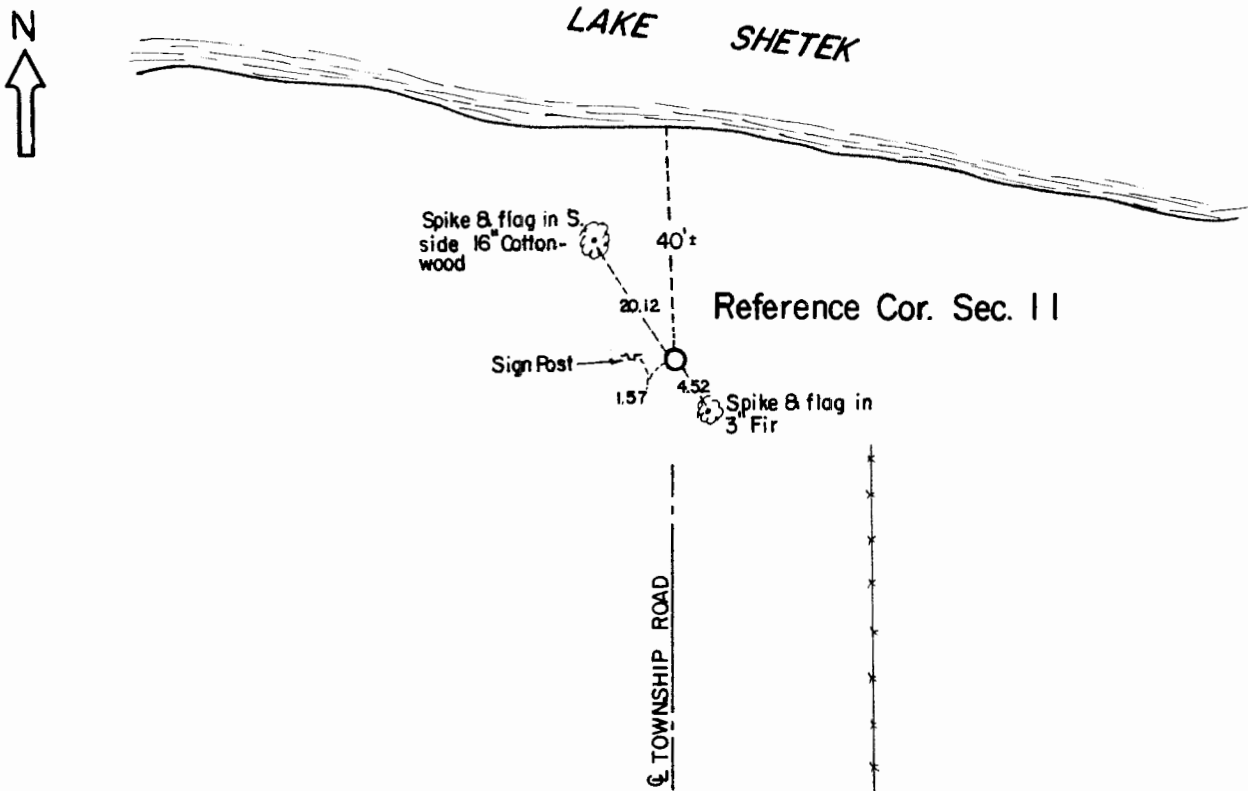

Statement of evidence relative to this corner location is on the back of page.

I hereby certify that this document and the data contained herein was prepared by me or under my direct supervision and that I am a duly Registered Land Surveyor under the laws of the State of Minnesota.

Duane A. Bonnema Nov 6, 1989
Duane A. Bonnema Date

Minnesota Registration No. 14895

OFFICE OF THE COUNTY RECORDER
COUNTY OF MURRAY
NOV 15 1989

I hereby certify that this document was filed in the County Recorder's office at ___ M. on the ___ day of _____ A.D., 19__

County Recorder [Signature]

By _____, Deputy

DOCUMENT NO. _____

Reference (East Line) Cor. Sec. 11 T107N-R41W

Statement:

- August 1861* *Original Government Land Office Surveyor L. G. M. Fletcher records in his field notes, "Set post at Cor ... built mound."*
- July 1964* *J. F. Richmond, LS Reg. No. 2129, platted ANDERT'S LAKESHORE ACRES. His plat used the section line between Sections 11 and 12.*
- June 1978* *Gary Martin, LS Reg. No. 12967 platted NORD'S SUB-DIVISION using the section line between Sections 11 and 12.*
- Sept. 28, 1989* *Duane A. Bonnema, LS Reg. No. 14895, placed a Minnesota Department of Transportation cast iron monument for a reference corner on the section line as determined by the 1964 and 1978 platting.*